

# LISKOW & LEWIS

A Professional Law Corporation

822 Harding Street  
Post Office Box 52008  
Lafayette, LA 70505  
(337) 232-7424 Main  
(337) 267-2399 Fax

One Shell Square  
701 Poydras Street, Suite 5000  
New Orleans, LA 70139  
(504) 581-7979 Main  
(504) 556-4108 Fax

First City Tower  
1001 Fannin Street, Suite 1800  
Houston, TX 77002  
(713) 651-2900 Main  
(713) 651-2908 Fax

www.Liskow.com

July 8, 2014

Richard W. Revels, Jr.  
rwrevels@liskow.com

Hon. James H. Welsh  
Commissioner of Conservation  
Office of Conservation  
P. O. Box 94275  
Baton Rouge, LA 70804-4275

Re: Tuscaloosa Marine Shale, Reservoir A  
Greenlaw Field  
Tangipahoa Parish, Louisiana

Dear Commissioner Welsh:

Application is hereby made on behalf of **HALCON LOUISIANA OPERATING, L.P.** for the calling of a public hearing, after legal notice, to consider evidence relative to the issuance of an order pertaining to the following matters:

1. To create one (1) additional drilling and production unit for the exploration for and production of oil and gas from the Tuscaloosa Marine Shale, in the Greenlaw Field, Tangipahoa Parish, Louisiana, said unit to be designated TMS RA SUB, as shown on the plat attached hereto and made a part hereof.
2. To force pool and integrate all separately owned tracts, mineral leases and other property interests within the proposed unit with each tract sharing in unit production on a surface acreage basis of participation.
3. Except as otherwise provided, to extend to the proposed additional unit all pertinent provisions of the order to be issued by Conservation as a result of a pending application filed on behalf of Goodrich Petroleum Company.
4. To consider such others matters as may be pertinent.

The Tuscaloosa Marine Shale, Reservoir A, in the Greenlaw Field, is hereby defined as being the stratigraphic equivalent of that oil and gas bearing zone encountered between the depths of 12,620 feet and 13,043 feet (electric log measurements) in the Oxy USA, Inc. – Richland Plantation A No. 1 Well located in Section 69, Township 1 South, Range 2 East, East Feliciana Parish, Louisiana, and is hereby further defined as being the stratigraphic equivalent of the section encountered between the depths of 11,470 feet and 12,000 feet (electric log

July 8, 2014

measurements) in the Sabine Corporation – Natalbany Lumber Co. Ltd. No. 1 Well, located in Section 15, Township 1 South, Range 6 East, St. Helena Parish, Louisiana.

Any pertinent data, including well logs, not available at the Office of Conservation, may be obtained **AT THE COST OF THE REQUESTING PARTY** from Bill Dale with W. H. Robbins & Associates, L.L.C., 302 LaRue France, Lafayette, Louisiana 70508, Telephone Number (337) 232-5004.

Pursuant to the Rules of Procedure, pre-application notice was given; however, no request for the conference was received. Therefore, the conference tentatively scheduled for July 17, 2014 **WILL NOT BE HELD**.

Attached hereto and made a part hereof is a plat outlining the applicant's proposal, along with a list of the names and addresses of the Interested Owners, Represented Parties, and Interested Parties to whom a copy of this application is being mailed. Pursuant to the Revised Rules of Procedure, the list of parties is being furnished **ONLY** to the Commissioner of Conservation and to the District Manager of the Lafayette District of the Office of Conservation; however, the list of parties will be furnished to any party requesting copies. A reasonable effort was made to ascertain the names and addresses of all Interested Owners, Represented Parties and Interested Parties.

Finally, enclosed is our check in the amount of \$755.00 made payable to the Office of Conservation submitted on behalf of the applicant representing the hearing application fee.

Sincerely,

LISKOW & LEWIS



Richard W. Revels, Jr.

RWRjr:dbf  
Attachments

cc: Mr. Richard Hudson, Lafayette District Office of Conservation  
cc: Interested Owners, Represented Parties and Interested Parties

4030402\_1  
36398.0013

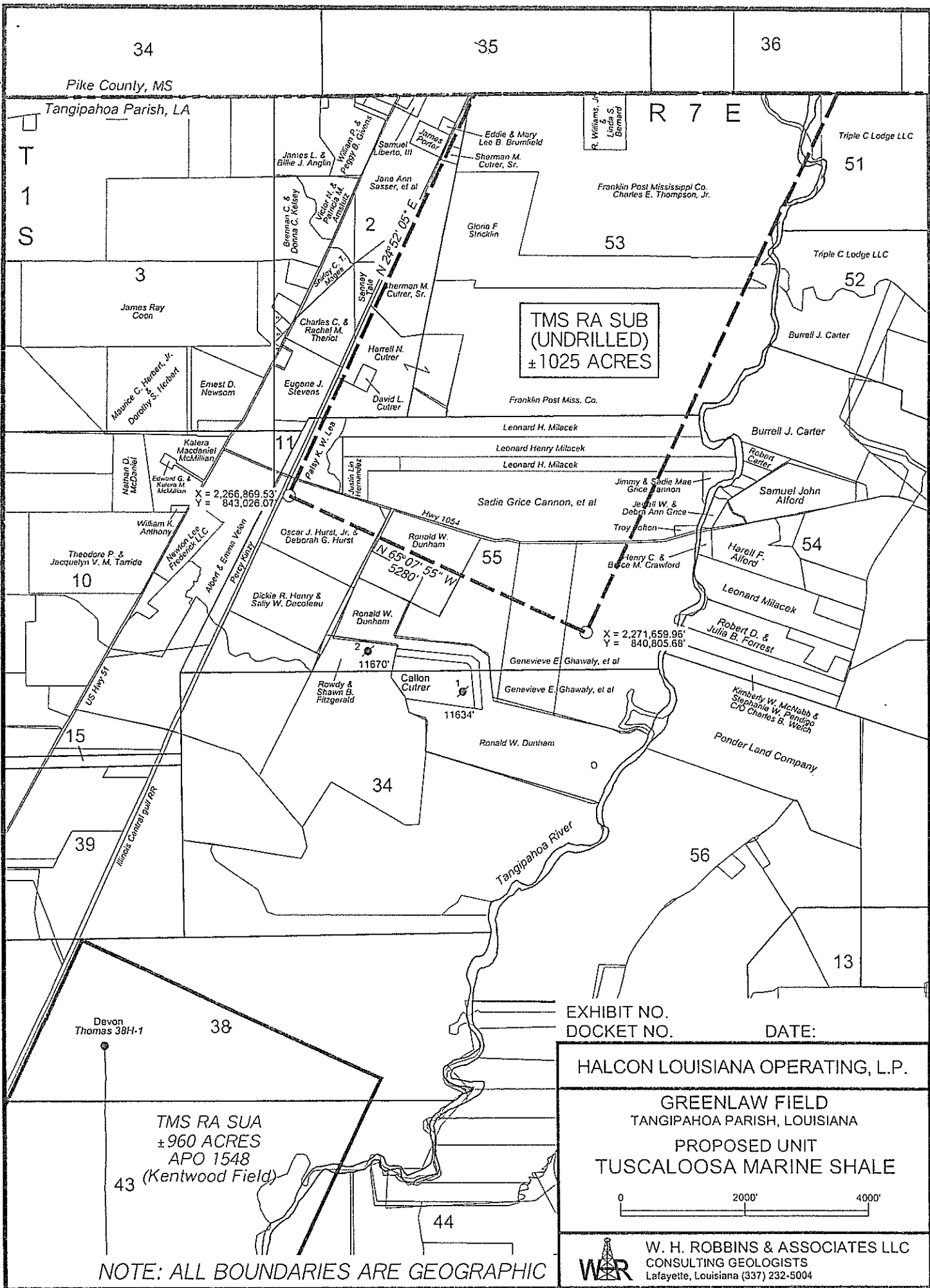

TMS RA SUB  
(UNDRILLED)  
± 1025 ACRES

Pike County, MS  
Tangipahoa Parish, LA

Devon Thomas 30H-1

TMS RA SUA  
± 960 ACRES  
APO 1548  
(Kentwood Field)

NOTE: ALL BOUNDARIES ARE GEOGRAPHIC

EXHIBIT NO. \_\_\_\_\_  
DOCKET NO. \_\_\_\_\_  
DATE: \_\_\_\_\_

HALCON LOUISIANA OPERATING, L.P.  
GREENLAW FIELD  
TANGIPAHOA PARISH, LOUISIANA  
PROPOSED UNIT  
TUSCALOOSA MARINE SHALE

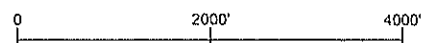

W. H. ROBBINS & ASSOCIATES LLC  
CONSULTING GEOLOGISTS  
Lafayette, Louisiana (337) 232-5004